

Rec: 17th Nov 2015
Consultation start 18th Nov 2015
End 15th Dec 2015

WK/201548144

Epping Forest District Council

Application for a premises licence to be granted under the Licensing Act 2003

PLEASE READ THE FOLLOWING INSTRUCTIONS FIRST

Before completing this form please read the guidance notes at the end of the form
If you are completing this form by hand please write legibly in block capitals. In all cases ensure that your answers are inside the boxes and written in black ink. Use additional sheets if necessary.
You may wish to keep a copy of the completed form for your records.

I/We JUST... AT THE STATION LTD apply for a premises licence under section 17 of
(Insert name(s) of applicant)
the Licensing Act 2003 for the premises described in Part 1 below (the premises) and I/we are making this application to you as the relevant licensing authority in accordance with section 12 of the Licensing Act 2003

Part 1 – Premises details

Postal address of premises or, if none, ordnance survey map reference or description <u>ROYDON STATION</u> <u>185 HIGH STREET</u> <u>ROYDON</u>	
Post town <u>ESSEX</u>	Post code <u>CM19 5EA 5EH</u>

Telephone number at premises (if any)

Non-domestic rateable value of premises

Part 2 - Applicant details

Please state whether you are applying for a premises licence as

Please tick ✓ yes

a) an individual or individuals*	<input type="checkbox"/>	please complete section (A)
b) a person other than an individual*		
i. as a limited company	<input checked="" type="checkbox"/>	please complete section (B)
ii. as a partnership	<input type="checkbox"/>	please complete section (B)
iii. as an unincorporated association or	<input type="checkbox"/>	please complete section (B)
iv. other (for example a statutory corporation)	<input type="checkbox"/>	please complete section (B)
c) a recognised club	<input type="checkbox"/>	please complete section (B)
d) a charity	<input type="checkbox"/>	please complete section (B)

- e) the proprietor of an educational establishment please complete section (B)
- f) a health service body please complete section (B)
- g) a person who is registered under Part 2 of the Care Standards Act 2000 (c14) in respect of an independent hospital please complete section (B)
- h) the chief officer of police of a police force in England and Wales please complete section (B)

*If you are applying as a person described in (a) or (b) please confirm:

Please tick yes

- I am carrying on or proposing to carry on a business which involves the use of the premises for licensable activities; or
- I am making the application pursuant to a
 - statutory function or
 - a function discharged by virtue of Her Majesty's prerogative

(A) INDIVIDUAL APPLICANTS (fill in as applicable)

Mr Mrs Miss Ms Other title (for example, Rev)

Surname **First names**

Please tick yes

I am 18 years old or over

Current postal address if different from premises address

Post Town **Postcode**

Daytime contact telephone number

E-mail address (optional)

SECOND INDIVIDUAL APPLICANT (if applicable)

Mr Mrs Miss Ms Other title (for example, Rev)

Surname

First names

Please tick
✓ yes

I am 18 years old or over

Current postal address if different from premises address

Post Town



Postcode

Daytime contact telephone number

E-mail address (optional)

(B) OTHER APPLICANTS.

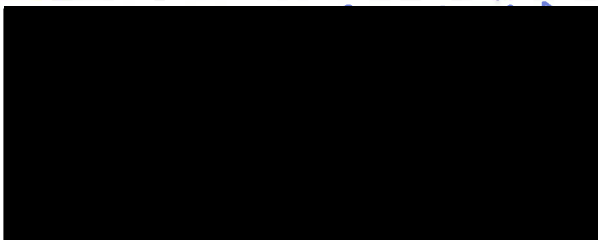
Please provide name and registered address of applicant in full. Where appropriate please give any registered number. In the case of a partnership or other joint venture (other than a body corporate), please give the name and address of each party concerned

Name	JUST... AT THE STATION LTD REG CO. NO. 9217614
Address	
Registered number (where applicable)	9217614
Description of applicant (for example partnership, company, unincorporated association etc)	LIMITED COMPANY
Telephone number (if any)	
E-mail address (optional)	

Part 3 Operating Schedule

When do you want the premises licence to start?

Day	Month	Year
17	11	2015

If you wish the licence to be valid only for a limited period, when do you want it to end?

Day	Month	Year

If 5,000 or more people are expected to attend the premises at any one time, please state the number expected to attend.

Please give a general description of the premises (please read guidance note 1)

Mediterranean Restaurant

What licensable activities do you intend to carry on from the premises?
(Please see sections 1 and 14 of the Licensing Act 2003 and Schedule 1 and 2 to the Licensing Act 2003)

Please tick ✓ yes

Provision of regulated entertainment

- a) plays (if ticking yes, fill in box A)
- b) films (if ticking yes, fill in box B)
- c) indoor sporting events (if ticking yes, fill in box C)
- d) boxing or wrestling entertainment (if ticking yes, fill in box D)
- e) live music (if ticking yes, fill in box E)
- f) recorded music (if ticking yes, fill in box F)
- g) performances of dance (if ticking yes, fill in box G)
- h) anything of a similar description to that falling within (e), (f) or (g)
(if ticking yes, fill in box H)

Provision of entertainment facilities for:

- i) making music (if ticking yes, fill in box I)
- j) dancing (if ticking yes, fill in box J)
- k) entertainment of a similar description to that falling within (i) or (j)
(if ticking yes, fill in box K)

Provision of late night refreshment (if ticking yes, fill in box L)

Supply of alcohol (if ticking yes, fill in box M)

In all cases complete boxes N, O and P

A

Plays Standard days and timings (please read guidance note 6)			Will the performance of a play take place indoors or outdoors or both – please tick [Y] (please read guidance note 2)	Indoors		
Day	Start	Finish		Outdoors		
Mon			Please give further details here (please read guidance note 3)	Both		
Tue						
Wed				State any seasonal variations for performing plays (please read guidance note 4)		
Thur						
Fri				Non standard timings. Where you intend to use the premises for the performance of plays at different times to those listed in the column on the left, please list (please read guidance note 5)		
Sat						
Sun						

B

Films Standard days and timings (please read guidance note 6)			Will the exhibition of films take place indoors or outdoors or both – please tick [Y] (please read guidance note 2)	Indoors		
Day	Start	Finish		Outdoors		
Mon			Please give further details here (please read guidance note 3)	Both		
Tue						
Wed				State any seasonal variations for the exhibition of films (please read guidance note 4)		
Thur						
Fri				Non standard timings. Where you intend to use the premises for the exhibition of films at different times to those listed in the column on the left, please list (please read guidance note 5)		
Sat						
Sun						

C

Indoor sporting events Standard days and timings (please read guidance note 6)			Please give further details (please read guidance note 3)
Day	Start	Finish	
Mon			<p>State any seasonal variations for indoor sporting events (please read guidance note 4)</p> <p>Non standard timings. Where you intend to use the premises for indoor sporting events at different times to those listed in the column on the left, please list (please read guidance note 5)</p>
Tue			
Wed			
Thur			
Fri			
Sat			
Sun			

D

Boxing or wrestling entertainments Standard days and timings (please read guidance note 6)			Will the boxing or wrestling entertainment take place indoors or outdoors or both – please tick [Y](please read guidance note 2)	
Day	Start	Finish	Indoors	Outdoors
Mon				
Tue				
Wed				
Thur				
Fri				
Sat				
Sun				

E

Live music Standard days and timings (please read guidance note 6)			Will the performance of live music take place indoors or outdoors or both – please tick [Y] (please read guidance note 2)	Indoors	<input checked="" type="checkbox"/>
Day	Start	Finish		Outdoors	
Mon	12.00	01.00	Please give further details here (please read guidance note 3) If we are hiring premises for a wedding/party we may like the possibility of live music	Both	
Tue	12.00	01.00			
Wed	12.00	01.00		State any seasonal variations for the performance of live music (please read guidance note 4)	
Thur	12.00	01.00			
Fri	12.00	01.00		Non standard timings. Where you intend to use the premises for the performance of live music at different times to those listed in the column on the left, please list (please read guidance note 5)	
Sat	12.00	01.00			
Sun	12.00	01.00			

F

Recorded music Standard days and timings (please read guidance note 6)			Will the playing of recorded music take place indoors or outdoors or both – please tick [Y] (please read guidance note 2)	Indoors	<input checked="" type="checkbox"/>
Day	Start	Finish		Outdoors	
Mon	11.00	01.30	Please give further details here (please read guidance note 3) If we are hiring premises or for background we will use recorded music.	Both	
Tue	11.00	01.30			
Wed	11.00	01.30		State any seasonal variations for playing recorded music (please read guidance note 4)	
Thur	11.00	01.30			
Fri	11.00	01.30		Non standard timings. Where you intend to use the premises for the playing of recorded music entertainment at different times to those listed in the column on the left, please list (please read guidance note 5)	
Sat	11.00	01.30			
Sun	11.00	01.30			

G

Performances of dance Standard days and timings (please read guidance note 6)			Will the performance of dance take place indoors or outdoors or both – please tick [Y] (please read guidance note 2)	Indoors	<input checked="" type="checkbox"/>
Day	Start	Finish		Outdoors	
Mon	12.00	01.00	Please give further details here (please read guidance note 3) <i>If we are using premises for a wedding / party they would like the possibility of dancing.</i>	Both	
Tue	12.00	01.00			
Wed	12.00	01.00		State any seasonal variations for the performance of dance (please read guidance note 4)	
Thur	12.00	01.00			
Fri	12.00	01.00		Non standard timings. Where you intend to use the premises for the performance of dance entertainment at different times to those listed in the column on the left, please list (please read guidance note 5)	
Sat	12.00	01.00			
Sun	12.00	01.00			

H

Anything of a similar description to that falling within (e), (f) or (g) Standard days and timings (please read guidance note 6)			Please give a description of the type of entertainment you will be providing		
Day	Start	Finish	Will this entertainment take place indoors or outdoors or both – please tick [Y] (please read guidance note 2)	Indoor	
Mon					Outdoor
Tue				Both	
Wed			Please give further details here (please read guidance note 3)		
Thur			State any seasonal variations for entertainment of a similar description to that falling within (e), (f) or (g) (please read guidance note 4)		
Fri					

Sat			<p>Non standard timings. Where you intend to use the premises for the entertainment of similar description to that falling within (e), (f) or (g) at different times to those listed in the column on the left, please list (please read guidance note 5)</p>
Sun			

<p>Provision of facilities for making music Standard days and timings (please read guidance note 6)</p>			<p>Please give a description of the facilities for making music you will be providing</p>							
			<p>Will the facilities for making music be indoors or outdoors or both – please tick [Y] (please read guidance note 2)</p>	<table border="1"> <tr> <td>Indoors</td> <td></td> </tr> <tr> <td>Outdoors</td> <td></td> </tr> <tr> <td>Both</td> <td></td> </tr> </table>	Indoors		Outdoors		Both	
Indoors										
Outdoors										
Both										
Day	Start	Finish								
Mon			<p>Please give further details here (please read guidance note 3)</p>							
Tue										
Wed										
Thur			<p>State any seasonal variations for the provision of facilities for making music (please read guidance note 4)</p>							
Fri										
Sat			<p>Non standard timings. Where you intend to use the premises for provision of facilities for making music entertainment at different times to those listed in the column on the left, please list (please read guidance note 5)</p>							
Sun										

<p>Provision of facilities for dancing Standard days and timings (please read guidance note 6)</p>			<p>Will the facilities for dancing be indoors or outdoors or both – please tick [Y] (see guidance note 2)</p>						
			<table border="1"> <tr> <td>Indoors</td> <td><input checked="" type="checkbox"/></td> </tr> <tr> <td>Outdoors</td> <td></td> </tr> <tr> <td>Both</td> <td></td> </tr> </table>	Indoors	<input checked="" type="checkbox"/>	Outdoors		Both	
Indoors	<input checked="" type="checkbox"/>								
Outdoors									
Both									
Day	Start	Finish	<p>Please give a description of the facilities for dancing you will be providing</p>						

Mon	12.00	01.00	Please give further details here (please read guidance note 3) If we are hiring premises for a wedding/party they may want to dance.
Tue	12.00	01.00	
Wed	12.00	01.00	State any seasonal variations for providing dancing facilities (please read guidance note 4)
Thur	12.00	01.00	
Fri	12.00	01.00	Non standard timings. Where you intend to use the premises for the provision of facilities for dancing entertainment at different times to those listed in the column on the left, please list (please read guidance note 5)
Sat	2.00	01.00	
Sun	2.00	01.00	

K

Provision of facilities for entertainment of a similar description to that falling within I or J Standard days and timings (please read guidance note 6)			Please give a description of the type of entertainment facility you will be providing	
Day	Start	Finish	Will the entertainment facility be indoors or outdoors or both – please tick [Y] (please read guidance note 2)	Indoor
Mon				Outdoor
				Both
Tue			Please give further details here (please read guidance note 3)	
Wed				
Thur			State any seasonal variations for the provision of facilities for entertainment of a similar description to that falling within j or k (please read guidance note 4)	
Fri				
Sat			Non standard timings. Where you intend to use the premises for the provision of facilities for entertainment of a similar description to that falling within I or J at different times to those listed in the column on the left, please list (please read guidance note 5)	
Sun				

L

Late night refreshment Standard days and timings (please read guidance note 6)			Will the provision of late night refreshment take place indoors or outdoors or both – please tick [Y] (please read guidance note 2)	Indoors	<input checked="" type="checkbox"/>	
Day	Start	Finish		Outdoors	<input checked="" type="checkbox"/>	
Mon	11pm	01.30am	Please give further details here (please read guidance note 3) <i>late night refreshments/tea + coffee to be used as a wind down.</i>	Both	<input type="checkbox"/>	
Tue	23.00	01.30				
Wed	23.00	01.30		State any seasonal variations for the provision of late night refreshment (please read guidance note 4)		
Thur	23.00	01.30				
Fri	23.00	01.30				
Sat	23.00	01.30		Non standard timings. Where you intend to use the premises for the provision of late night refreshment at different times, to those listed in the column on the left, please list (please read guidance note 5)		
Sun	23.00	01.30				

M

Supply of alcohol Standard days and timings (please read guidance note 6)			Will the sale of alcohol be for consumption (Please tick box Y) (please read guidance note 7)	On the premises	<input checked="" type="checkbox"/>
Day	Start	Finish		Off the premises	<input checked="" type="checkbox"/>
Mon	11pm	01.00am	State any seasonal variations for the supply of alcohol (please read guidance note 4)	Both	<input type="checkbox"/>
Tue	11.00	01.00			
Wed	11.00	01.00			
Thur	11.00	01.00	Non-standard timings. Where you intend to use the premises for the supply of alcohol at different times to those listed in the column on the left, please list (please read guidance note 5)		
Fri	11.00	01.00			
Sat	11.00	01.00			

Sun	11.00	08.00	
-----	-------	-------	--

State the name and details of the individual whom you wish to specify on the licence as premises supervisor

Name: THOMAS ANDREW HOWE

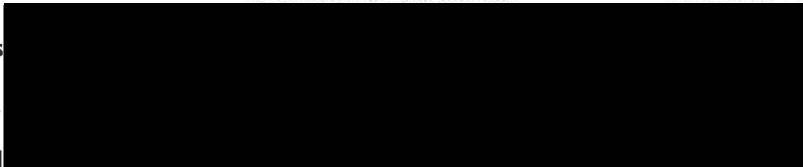
Address: 

Postcode: 

Personal Licence number(if known): Awaiting LBWF

Issuing licensing authority (if known): Awaiting LBWF

N

Please highlight any adult entertainment or services, activities, other entertainment or matters ancillary to the use of the premises that may give rise to concern in respect of children (please read guidance note 8)

O

Hours premises are open to the public Standard timings (please read guidance note 6)			State any seasonal variation (please read guidance note 4)
Day	Start	Finish	
Mon			
Tue			
Wed			
Thur			
Fri			
Sat			
Sun			

Non standard timings. Where you intend to use the premises to be open to the public at different times from those listed in the column on the left, please list (please read guidance note 5)

P

Describe the steps you intend to take to promote the four licensing objectives:

a) General – all four licensing objectives (b,c,d,e) (please read guidance note 9)

~~THE PREMISES WILL INS~~

b) The prevention of crime and disorder

THE PREMISES WILL INSTALL AND MAINTAIN CCTV SYSTEM WHICH WILL RECORD FOR 28 DAYS. THIS WILL BE AVAILABLE IMMEDIATELY UPON ^{LAWFUL} REQUEST OF ESSEX POLICE OR RESPONSIBLE AUTHORITY. A STAFF MEMBER WILL BE CONVERSANT WITH CCTV SYSTEM AND AVAILABLE WHEN PREMISES ARE OPEN TO THE PUBLIC.

c) Public safety

Reasonable and adequate staff training will be carried out in relation to
a) dealing with incidents and crime/disorder prevention.
b) sale of alcohol to underage, persons over 18 purchasing for underage, drunk etc) prior to being allowed to sell alcohol.

d) The prevention of public nuisance

Notices shall be prominently displayed at all exits requesting patrons to leave quietly.

e) The protection of children from harm

The premises shall operate a challenge 25 age verification policy. Any person who appears to be under 25 shall be asked to produce photo I.D. to prove they are over 18. Failure to produce will result in service being refused. Acceptable forms of ID include:
a) Passport b) Photocard driving licence.
c) Photographic ID bearing 'PASS' hologram.

Please tick ✓ yes

- I have made or enclosed payment of the fee
- I have enclosed the plan of the premises
- I have sent copies of this application and the plan to responsible authorities and others where applicable
- I have enclosed the consent form completed by the individual I wish to be premises supervisor, if applicable
- I understand that I must now advertise my application
- I understand that if I do not comply with the above requirements my application will be rejected

IT IS AN OFFENCE, LIABLE ON CONVICTION TO A FINE UP TO LEVEL 5 ON THE STANDARD SCALE, UNDER SECTION 158 OF THE LICENSING ACT 2003, TO MAKE A FALSE STATEMENT IN OR IN CONNECTION WITH THIS APPLICATION

Part 4 – Signatures (please read guidance note 10)

Signature of applicant or applicant's solicitor or other duly authorised agent. (See guidance note 11) If signing on behalf of the applicant please state in what capacity.

Signature 

Date 17/11/15

Capacity COMPANY SECRETARY

For joint applications signature of 2nd applicant or 2nd applicant's solicitor or other authorised agent. (please read guidance note 12) If signing on behalf of the applicant please state in what capacity.

Signature

Date

Capacity

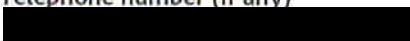
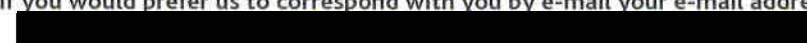
Contact name (where not previously given) and postal address for correspondence associated with this application (please read guidance note 13)	
Post town	Post code
Telephone number (if any) 	
If you would prefer us to correspond with you by e-mail your e-mail address (optional) 	

Epping Forest District Council

Consent of individual to being specified as premises supervisor

I THOMAS ANDREW HOWE (insert name of prospective premises supervisor)

Of  (home address of prospective premises supervisor)

hereby confirm that I give my consent to be specified as the designated premises supervisor in relation to the application for variation of designated premises supervisor

by JUST... AT THE STATION (name of applicant)

relating to premises licence N/A (number of existing licence if any)

for JUST... AT THE STATION LTD
185 HIGH STREET
ROYDON ESSEX CM19 5EA
(name and address of premises to which application relates)

and any premises licence to be granted or varied in respect of this application made by the above applicant concerning the supply of alcohol at the above named premises.

I also confirm that I am applying for, intend to apply or currently hold a personal licence, details of which I set out below.

Personal Licence Number AWAITING (insert personal licence number, if any)

Personal licence issuing authority AWAITING LBWF (insert name, address and telephone number of issuing authority, if any)

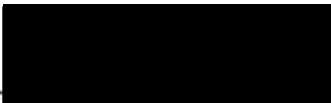
Signed 

Print Name THOMAS ANDREW HOWE

Dated 17/11/15

LICENSE DRAWING FOR RESTAURANT UNIT AT ROYDON STATION

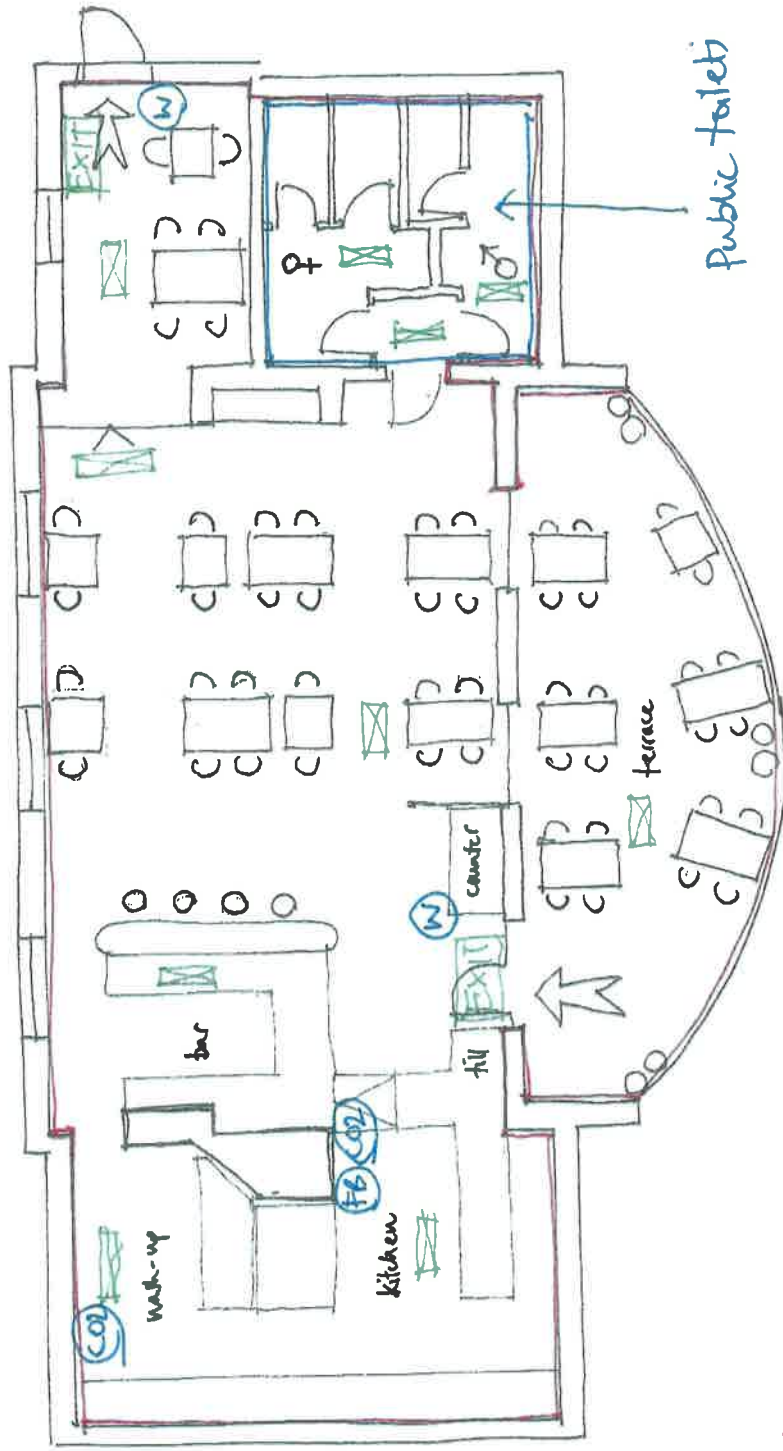

— extent of premises.

☒ emergency lighting.

EXIT emergency exit sign - maintained

FB fire blanket

CO2 CO2 extinguisher

W water extinguisher

0 5 metres

1:100 @ A4.



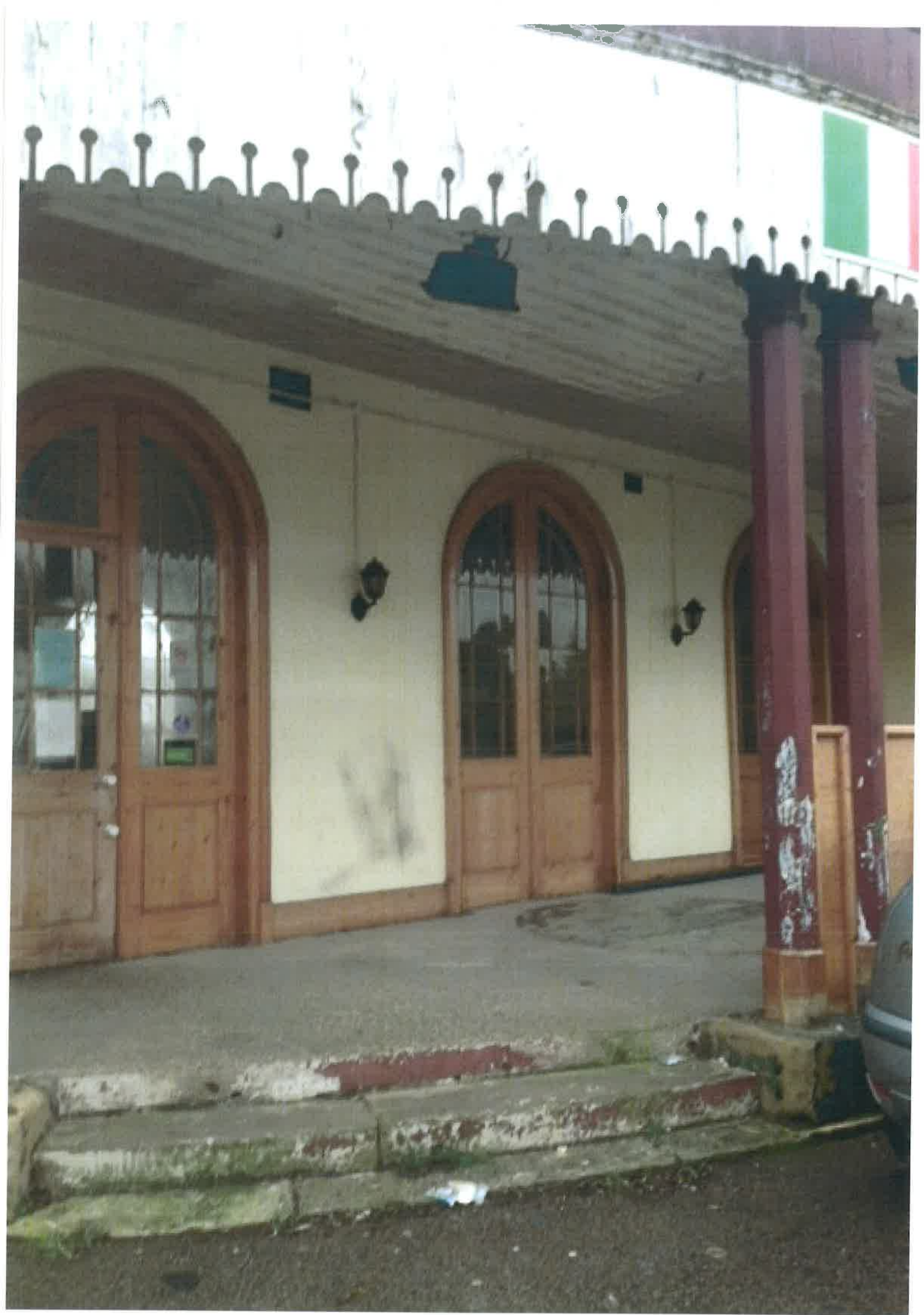

Public Notices

INSOLVENCY ACT 1986

IN BANKRUPTCY HERTFORD COUNTY COURT

NO 77 of 2006 RE JUSTIN MARK BLISS Who at the date of the bankruptcy order 9/2/2006, resided at 30 Elm Road, Bishop's Cleeve, Hertfordshire CM23 2SS and carried on business as 'J&J Hair' from 105B Rye Street, Bishop's Cleeve, Hertfordshire CM23 2HD.

D.O.B: 24 September 1966 NOTE: The above-named was discharged from the proceedings and may no longer have a connection with the addressee listed.

I intend to pay within four months from 29th December 2015 (being the last day for proving) the first and final dividend of 1.0%. Creditors who have not yet proved their debts must do so by 29th December 2015 (being the last day for proving) otherwise they will be excluded from the dividend. The required proof of debt form is available on the Insolvency Service website (www.bis.gov.uk/insolvency, select 'Forms' and then form 6.37). Alternatively, you can contact my office at LIAO, PO Box 490, Ipswich, Suffolk IP1 1YR telephone 01473 389535 to supply a form.

Mr D Gibson, Official Receiver and trustee

SAVE TIME AND MONEY by selling on your mobile



market PLACE

Planning Notices

NOTICE OF PUBLIC PATH ORDER

TOWN AND COUNTRY PLANNING ACT 1990, SECTION 257 AND PARAGRAPH 1 OF SCHEDULE 14

EAST HERTFORDSHIRE DISTRICT COUNCIL BUNTINGFORD NO. 12 DIVERSION ORDER 2015

The above order was made on 26 November 2015. The effect of the order will be to divert Buntingford Footpath 17 from TL 3658 2959 running generally south east to Hare Street Road at TL 3678 2942 to a new alignment commencing at a junction with Buntingford Footpath 12 at TL 3658 2959 and running generally north east for approximately 10 metres to TL 3659 2959 then running generally south east along the southern footway of the new estate road for approximately 60 metres to TL 3663 2958. Then continuing generally south through the open space adjacent to the playground for approximately 100 metres to TL 3666 2951. Then crossing the new estate road and running generally south east; along the northern eastern footway for approximately 120 metres to TL 3676 2945 then crossing the new estate road and continuing generally south east, south and south west; for approximately 50 metres to a junction with Hare Street Road at TL 3677 2941 as shown on the Order Plan.

A copy of the Order and the Order Plan may be seen free of charge at East Hertfordshire District Council from 9.00 am to 5.00 pm Monday to Friday. Copies of the Order and Plan may be bought there at the price of £5.00. Any representation about or objection to the Order may be sent or delivered in writing addressed to the Mrs. J. Blackman, Democratic Services Officer, East Hertfordshire District Council, Wallfields, Pegg Lane, Hertford SG13 8EQ, later than 24 October 2015. Please state the grounds on which it is made.

If no such representations or objections are made, or if any so made are withdrawn, the East Hertfordshire District Council may itself confirm the order as an unopposed order. If the order is sent to the Secretary of State for the Environment for confirmation any representations or objections which have not been withdrawn will be sent with the order.

Dated: 26 November 2015

Jeff Hughes Head of Democratic and Legal Support Services East Herts District Council Wallfields Pegg Lane Hertford SG13 8EQ www.eastherts.gov.uk

Planning Notices



TOWN AND COUNTRY PLANNING ACT 1990 LOCALISM ACT 2011

Hertingfordbury Parish Council

East Herts Council has received an application for the designation of a Neighbourhood Area

A copy of the area application can be viewed on the Council's website (www.eastherts.gov.uk) and at the Councils Office, Wallfields, Pegg Lane Hertford SG13 8EQ (Mon - Fri 10am - 5pm)

Any interested person may submit representations in relation to the application. These must be made in writing and submitted to East Herts Council by post (to the above address) or by e-mail to planningpolicy@eastherts.gov.uk

Representations must be received by 5pm on Thursday 17th December 2015.

Please note that any representations submitted will be available for public inspection.

www.eastherts.gov.uk



TOWN AND COUNTRY PLANNING ACTS 1990

The following applications have been made to East Herts Council

Full Application

3/15/1910/FUL & 3/15/1911/LBC at New House Farm, Wende, SG12 7QT - Conversion of 1st and 2nd floors of buildings to 31 legal industrial workshops. 3/15/2197/L & 3/15/2198/LBC at Grass Farm, South, Green Tree, Much Hadham, SG10 6DP - Conversion on and restoration of barn to provide accommodation - full details on website. 3/15/2254/FUL & Land at Mill Farm, Mentilly Lane, Great Munden, SG11 1JR - Change of use from agriculture to mixed use - agriculture / generation of renewable energy (Solar) - amended scheme.

Listed Building Consent

3/15/2207/LBC at The Stable Block, 1 Lower Water House, Tewin - Remove rear windows to create new doors on rear width of current door, internal alterations - full details on website. 3/15/2276/LBC at Benington Park, Benington, SG7 7BU - Change of use from stables to mini to distillery. 3/15/2258/LBC at 4 Yeomans Drive, Aston, SG2 7ED - Brick up existing doors, open central archway. 3/15/2162/LBC at Skilton Strip, Cherry Green, Westmill, SG9 9NN - New clay chimney pot.

Householder

3/15/2270/HH at 60 Wellington Street, Benige, SG14 3AN - Proposed side extension. 3/15/2242/HH at Walker Mill House 151 High Street, Woburn, SG2 7NP - Demolition of multiple rooms and proposed extensions - full details on website. 3/15/2251/HH at 5 The Chestnuts, Hertford, SG13 8AQ - Two storey front, side and rear extensions on insert on of 5no velux rooflights. 3/15/2157/HH at 1F Byde Street, Benige, SG14 3AL - Ground floor side and first floor rear extensions.

Variation of condition

3/15/2354/VR at Land at Marshgate Trading Estate, Marshgate Drive, Hertford SG13 7AQ - Renew condition 14 of 3/10/1147/PN (provision of on site childrens play area) variation of S106 for funding of play provision.

All applications are available on the Council's website but for further details of the locations where you can inspect them, and how to comment on them, please call us on 01729 655761 or visit the Councils website. The Council gives warning pursuant to its powers under section 225 of the Town & Country Planning Act 1990, that it will remove or alter any placard or poster displayed illegally within the administrative boundaries of East Hertfordshire District Council.

www.eastherts.gov.uk

TOWN AND COUNTRY PLANNING ACT, 1990

The following applications have been made to Broxbourne Borough Council

Installation of golden gravel shingle driveway to front garden - 19 Wenitworth Cottages Cozens Lane West Wormley EN10 6GJ (Ref: 07/15/1078/HF)

Single storey side and rear extension and demolition of existing conservatory - 52 Stellan Road Broxbourne EN10 7AL (Ref: 07/15/1071/HF)

Installation of 46" advertisement television to front and side elevations - 3 Fawken Walk Hodeadon EN11 8TL (Ref: 07/15/1074/AC)

Roof Terrace - 9 The Coach House Hogges Close Hodeadon EN11 8EY (Ref: 07/15/1094/F)

Timber frame outbuilding ancillary to dwelling house at rear of garden for elderly relative - 19 Wenitworth Cottages Cozens Lane West Wormley EN10 6GJ (Ref: 07/15/1093/HF)

Single storey rear extension - 19 Wenitworth Cottages Cozens Lane West Wormley EN10 6GJ (Ref: 07/15/1097/HF)

The above applications may be inspected at www.broxbourne.gov.uk, the Borough Offices, the Council One Stop Shops or any Public Library. Representations must be made within 14 days from the date of this advert.

Douglas Cooper Head of Planning & Development

BUY & SELL wherever you are!

Licensing Notices

Notice of Application for a New Premises Licence under the Licensing Act 2003

Notice is given this day 17th November 2015 that Just... at the station Ltd has applied to the Licensing office of Epping Forest District Council for a Premises Licence in respect of 195 High Street, Roydon, Essex, CM19 5EH

The proposed licence is for: sale of alcohol 11:00-01:00; Recorded music 11:00-01:00; Live music 12:00-01:00; Performance of dance, 12:00-01:00; Provision of facilities for dancing 12:00-01:00; Late night refreshment 23:00-01:30

The register of licensed premises is maintained at the Licensing Office of Epping Forest District Council, Civic Offices, High Street, Epping, Essex, CM16 4BZ. Applications for premises licences may be inspected at this office during office hours. Anyone wishing to oppose this application must give written notice to the Licensing Office within 28 days of this notice.

It is an offence knowingly or recklessly to make a false statement in connection with an application which could lead to a fine on summary conviction (maximum £5000).

Mercury herfordshiremercury.co.uk DATE LOCALLY Life is Local

Here's how to use your Date Locally dating service... Place a FREE advert... To Reply to members... Or Text... Date ONLINE... Be an left a message?

female seeking DENISE attractive 30's female... MELANIE, Tanned, toned... DIANE 37, romantic sentimental... SUZANNE, lovely, mature, slim... KATIE 35yrs, slender well educated... DEBBIE, 43, dark haired passionate... TANNED (tanned red haired) temptress... EXTREMELY nice, attractive lady... LIKE uniforms? Sexy, sexy nurse... CLAUDE young 38, beautiful slim blonde... JEAN, I am 60 years old I am looking for a gentleman... CAREING, loving, good to be with female, enjoys swimming... LORRAINE single mum new to the area... BUE, lovely sensual brunette... DEBRA, tall busty female, endless legs... SOPHIA young 40yrs, married but bored, seeks discreet adult fun... MAUREEN, discreet sensual lady, 42yrs seeks daytime fun at her home... LOVING, caring, black professional female, late 40s, WLMT... GOSH, WLMT rice guy to cuddle up with and appreciate... STEVE looking for N/S female... YOUNG looking, 75 year old guy... LANDSCAPE builder, wrong side of 40, hopeless romantic... ANTHONY, active, working, early 70s, non-smoker, divorced...

MOBILE LOVE MATCH TEXT MATCH TO 89990

male seeking

ADULTS ONLY Try saucy contacts, its FREE to view visit www.saucycontacts.com

CUSTOMER SUPPORT Call 0207 720 7130 Monday - Friday 10am - 4pm or email us at support@jmediauk.co.uk

CALL CHARGES: DATING 18+ and have the bill payers permission. 0644 calls cost 7 pence per min, 090 calls cost £1.55 per min, plus your phone company's access charge. Calls are recorded and may appear on your bill. TEXT: Text alerts are charged at £1.50 per week. To unsubscribe to text alerts, text DATING STOP to 83333. To cancel text match alerts, text STOP to 07781474042. For full T&Cs go to www.j-media-uk.com. REPLY BY TEXT: 80098/89990 costs £1.50 per SMS received (max 150 characters). Guaranteed up to 4 messages for each message you send. Service only available where phone icon shown. Messages are moderated. Minimum 7 messages must be sent before contact details can be exchanged. This service is not computer generated. All messages are responded to by real service users. No meetings can be guaranteed. If arranging a meeting be sure to choose a public space and do not give personal details to people you have not met. To STOP text stop to 80098/89990. Service provided by J Media UK Ltd. Help: 0207 720 7130. ALL SERVICES: By using any short code you consent to the owner of that shortcode sending you the occasional marketing message. To opt out of receiving this send NO INFO to 80098. DATA PROTECTION: Service provided by J Media UK Ltd, BSW 78K, 0207 720 7130. We will collect the details you provide and may send you details of other services and events operated by us. We may pass your details onto this newspaper for marketing or Phone-PlayPlus for regulatory purposes. Advertisers may come from our national database and from our pdd app. w/c 23/11/15

Mrs K Tuckey
Licensing Department
Epping Forest District Council
Civic Offices
High Street
Epping
CM16 4BZ



Licensing Department
Loughton Police Station
158 High Road
Loughton
IG10 4BE
Tel: 01279 625 405
Email: 7706@essex.pnn.police.uk

10 December 2015

Dear Mrs Tuckey,

LICENSING ACT 2003 – GRANT OF PREMISES LICENCE SECTION 17

NEW PREMISE: At The Station, Roydon

DPS: Thomas Howe

APPLICANT: Just...At The Station Ltd

Further to the above application for the Grant of a Premises Licence received on 19 November 2015. I write to inform you that Essex Police make representations under prevention of crime & disorder, prevention of public nuisance and public safety and protection of children from harm.

The premises are in close proximity to a train crossing, with access to live track. It is also close to residential dwellings. For those reasons Essex Police would seek the following conditions.

1. The premises shall install and maintain a comprehensive CCTV system covering the internal and external of the premises. It will also cover all entry and exit points enabling full frontal identification of every person entering in any light condition. The CCTV system shall continually record whilst the premises is open to the public and during all times when customers remain on the premises. All recordings will be kept in an unedited format for a period of not less the 28 days with time and date stamping. Recording shall be made available immediately upon lawful request of Essex Police or other Responsible Authority. Download or export of CCTV should be in the native file format with the native player.

A staff member from the premises who is conversant with the operation of the CCTV system shall be available at all times when the premises are open to the public. This staff member must be able to show Essex Police or other Responsible Authority recent data or footage with the absolute minimum of delay.

2. The external areas of the premises shall not be for the consumption of food or drink.
3. A designated smoking area will be established. After 21:00 daily the smoking area shall be restricted to 5 at any time. No drinks or glassware to be permitted in the smoking area.
4. The premises shall operate a Challenge 25 age verification policy. Any person who appears to be under the age of 25 shall be asked to produce photographic

In an emergency always dial **999**. For non emergencies dial **101**.

www.essex.police.co.uk

identification to prove they are 18 or over. Failure to produce will result in service being refused. Acceptable forms of photographic identification include:

- a) Passport,
- b) Photo card Driving Licence,
- c) Photographic ID bearing the 'PASS' hologram.

Should the applicant agree to these conditions prior to the consultation end date 15th December, Essex Police shall withdraw.

Please advise when the Licensing Panel will be meeting to hear this so I can be in attendance.

Yours sincerely,



Mr Peter Jones ABII
Epping & Brentwood Licensing Officer
West LPA

Cc. Just...At The Station Ltd (via email just_atthestation@yahoo.co.uk)

Sarah Moran

From: Peter Jones 42007706 <Peter.Jones@essex.pnn.police.uk>
Sent: 16 December 2015 10:17
To: 'Tom Howe'
Cc: Licensing
Subject: RE: Just...At The Station - Premises Application

Good morning Helen,

Further to the below correspondence, and a long telephone discussion, I am happy to remove proposed condition 2, and amend proposed condition 3 to:

A preferred smoking area will be situated to the left of the premises as you exit.. No drinks or glassware to be permitted in the smoking area.

With that, and Proposed conditions 1 & 2 being agreed, Essex Police are happy to withdraw their representation.

Kind Regards,

Peter Jones ABII (7706)

Epping & Brentwood Licensing Officer
Epping Forest & Brentwood Local Policing Hub
West LPA

Tel. 101 (Ext. 313604) or 01279 625405

Peter.Jones@essex.pnn.police.uk

www.essex.police.uk

Loughton Police Station, 158 High Road, Loughton, Essex, IG10 4BE

To find out what is happening in your neighbourhood and all about your local neighbourhood policing team visit www.essex.police.uk/yourarea and enter your postcode.



ESSEX COMMUNITY MESSAGING

Sign up for free to receive accurate and up-to-date information, crime prevention advice and notifications from Essex Police and other key partners, such as Neighbourhood Watch - simply click the following link <http://www.essex.police.uk/ecm>

From: Tom Howe [mailto:just_atthestation@yahoo.co.uk]
Sent: 14 December 2015 16:13
To: Peter Jones 42007706; Emma Matthews INSP 42002633
Cc: 'just_atthestation@yahoo.co.uk'
Subject: Re: Just...At The Station - Premises Application

Dear Peter,

Further to your email on Friday with the attached letter, I would like to thank you for taking the time to speak to me today.

As we discussed conditions 2 and 3 give me a cause for concern :-

2) The external covered area that is included in the diagram has always been used as an 'alfresco' dining area and as a small restaurant it is integral to our running of the restaurant business and the consuming of food and drink. I would be grateful if you could remove this restriction.

3) Given the restaurant capacity the number of people smoking outside is likely to be minimal. The preferred area for people wishing to smoke would be to the left as you exit the premises where ashtrays would be available for customers to extinguish any cigarettes, as has been done by the previous restaurateur. No drinks or glassware would be permitted outside of the restaurant dining area. It would be onerous on us as a small business to restrict the number of persons smoking at any one time and I would be grateful if this condition could be removed.

I am happy to agree with your other conditions and look forward to working with you in the future.

Kind regards and many thanks,

Helen

On Friday, December 11, 2015, 9:50 AM, Peter Jones 42007706 <Peter.Jones@essex.pnn.police.uk> wrote:

Good Morning,

Please find letter attached relating to the above application,

Many Thanks

Peter Jones ABII (7706)

Epping & Brentwood Licensing Officer

Epping Forest & Brentwood Local Policing Hub

West LPA

 Tel. 101 (Ext. 313604) or [01279 625405](tel:01279625405)

 Peter.Jones@essex.pnn.police.uk

 www.essex.police.uk

 Loughton Police Station, 158 High Road, Loughton, Essex, IG10 4BE

To find out what is happening in your neighbourhood and all about your local neighbourhood policing team visit www.essex.police.uk/yourarea and enter your postcode.

Essex County Fire & Rescue Service

23 NOV 2015



Mr Adam Eckley, MBA, M.I.Fire.E
Acting Chief Fire Officer and Acting Chief Executive

Sarah Moran
Licensing Enforcement Officer
Licensing Unit
Civic Offices
323 High Street
Epping
CM16 4BZ

WEST AREA COMMAND
Harlow Service Delivery Point
Fourth Avenue
HARLOW
CM20 1DU
☎ 01376 576800
✉ westareacommand@essex-fire.gov.uk

Date: 19 November 2015
Our Ref: 70/100091440288
Your Ref:
Enquiries to: Steve Nicholl

Dear Madam,

LICENSING ACT 2003

THE REGULATORY REFORM (FIRE SAFETY) ORDER 2005

Premises: Roydon Station 185 High Street Roydon CM19 5EA

Receipt is acknowledged of the above consultation, which will be audited by the Essex Fire Authority (The Authority).

Should there be any significant concerns regarding the application you will be notified in due course.

Yours faithfully

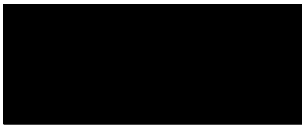

S. W. Nicholl
Technical Fire Safety Officer

Sarah Moran

From: Hasan Erdogan
Sent: 20 November 2015 11:23
To: Sarah Moran (GCSX)
Subject: RE: Licensing Act 2003 New Premises licence application

Hi Sarah,

I have no comments to make regarding the application below.

Thanks,

Hasan

From: Sarah Moran (GCSX)
Sent: 18 November 2015 10:50
To: ECC; ECC 2; eNVIROMENT AGENCY; Fire; Health and safety; Jackie Renn; Peter Jones; Richard Gardiner (GCSX); Hasan Erdogan; licensing.applications@essex.pnn.police.uk
Cc: [REDACTED]; Democratic Services
Subject: Licensing Act 2003 New Premises licence application

Dear all,

Please be advised that under the Licensing Act 2003 the Licensing Unit has received an application online for a New Premises licence, received on Tuesday 17TH November 2015

Applicant: Just at the Station Ltd

Address of premises: Roydon Station, 185 High Street, Roydon Essex CM19 5EA

Licensable Activities:

New Premises Application – Mediterranean Restaurant

Live Music	Mon – Sun 12.00 – 01.00hrs
Recorded Music	Mon – Sun 11.00 – 01.30hrs
Performances of dance	Mon – Sun 12.00 – 01.00hrs
Dancing	Mon – Sun 12.00 – 01.00hrs
Late night Refreshment	Mon – Sun 23.00 – 01.30hrs
Sale of Alcohol	Mon – Sun 11.00 - 01.00hrs

Consultation Start: Wed 18TH November 2015

Consultation End: Tues 15th December 2015

If you wish to make any representations please do so before **Tuesday 15th December 2015**

Please send any representations to:

Licensing Unit, Civic Offices, 323 High Street, Epping, Essex, CM16 4BZ

Sarah Moran

From: Sue Parker, Business Support Administrator <Sue.Parker2@essex.gov.uk> on behalf of Licence Applications CYP <LicenceApplications@essex.gov.uk>
Sent: 30 November 2015 12:01
To: Licensing
Cc: Just_atthestation@yahoo.co.uk
Subject: 11-2015/14 Just At The Station Ltd Licence Application

RE: Licensing Act 2003:- Just At The Station Ltd

The licensing application received on 25/11/2015 has been assessed and we can confirm we have no objections in relation to the child protection / safeguarding element of this licence application.

Licensing Applications
Quality Assurance & Safeguarding (inc IRO) Service
Family Operations
E2, County Hall
Chelmsford CM1 1YS
Tel: 033301 39797 Email: LicenceApplications@essex.gov.uk

Regards

Sue Parker
Business Support Administrator – BC3
Corporate and Customer Services

Essex County Council
Telephone: 0333 0138888
Email: businesscentre3@essex.gov.uk | www.essex.gov.uk

This email (including any attachments) is intended only for the recipient(s) named above. It may contain confidential or privileged information and should not be read, copied or otherwise used by any other person unless express permission is given. If you are not a named recipient, please contact the sender and delete the email from your system. It is the recipient's responsibility to ensure that appropriate measures are in place to check for software viruses.

Sarah Moran

From: Sarah Moran (GCSX)
Subject: FW: New Premises Application – Mediterranean Restaurant, Roydon Station, 185 High Street, Roydon

From: Mary Sartin [<mailto:marysartin@yahoo.com>]
Sent: 14 December 2015 17:00
To: Sarah Moran (GCSX)
Subject: New Premises Application – Mediterranean Restaurant, Roydon Station, 185 High Street, Roydon

Applicant: Just at the Station Ltd

Address of premises: Roydon Station, 185 High Street, Roydon Essex CM19 5EA

Licensable Activities:

New Premises Application – Mediterranean Restaurant

Live Music	Mon – Sun 12.00 – 01.00hrs
Recorded Music	Mon – Sun 11.00 – 01.30hrs
Performances of dance	Mon – Sun 12.00 – 01.00hrs
Dancing	Mon – Sun 12.00 – 01.00hrs
Late night Refreshment	Mon – Sun 23.00 – 01.30hrs
Sale of Alcohol	Mon – Sun 11.00 - 01.00hrs

Dear Sarah

I wish to register my concerns regarding this application for a new premises licence. I know that there is considerable concern about this application within the vicinity of the premises and beyond as it is perceived as being an opening up to a much wider use than that of just a restaurant.

I will contain my own comments to the licensing objective of Prevention of Public Nuisance which includes noise nuisance. I feel that the proposed sale of alcohol to 1am and late night refreshments to 1.30am could lead to clientele leaving the premises at a time and in a manner which could cause a nuisance particularly to those people living directly opposite the building. The fact that these hours are being sought for 7 days a week also seems excessive for a business which is being run as a restaurant. I would therefore ask that consideration be given to reducing the hours when licensable activities can take place.

I am also concerned that the building, as it stands at present, is not of a structure that will easily contain sound from the activities which could be taking place within it. I would ask that in granting a licence to this premises consideration be given to conditioning ways in which the sound of live and recorded music could be contained within the building and that a noise monitoring policy be put in place.

Regards

Mary Sartin

High Street
Roydon
Essex
CM19 5EQ

From: [REDACTED]

Sent: 13th December 2015

To: licensing@eppingforestdc.gov.uk

Subject: Licence application 'Just at the Station, Roydon' ref. WK/201548144

Dear Sir or Madam

We are not against this application in principle as we have appreciated having a well-run and in-keeping restaurant on the site in the past. It would be good to see a similar business start up.

However, the application to run this as a live music venue, open to the early hours is not a sensible one and we would suggest that it should be toned down on the grounds of Public Safety, prevention of public nuisance and prevention of crime and disorder.

Public safety. The building, being the old station, is immediately adjacent to the main railway line and the level crossing. The line carries express trains to and from Stansted, as well as other traffic. There is nothing to stop people wandering on to the lines if the crossing barriers are up. When the barriers are down pedestrians have to wait to access the southbound platform as there is no pedestrian bridge. Sober people respect this but anyone whose judgment is impaired by alcohol could be tempted to jump the low barriers to catch the last train home, or just to get back into the village.

The location is also adjacent to the river. There have been drownings in the past at other establishments nearby, following late night drinking.

Public nuisance. The village does not have late night public transport. The station is unmanned and has no service information or help with taxis or other transport. We already have people knocking on doors here after falling asleep on the train and getting off confused in Roydon. Late night drinking at the venue would exacerbate this.

The noise from live music every night until 1.30 would be another nuisance.

Crime and disorder. The immediate area and the rail facilities (the waiting area, for example) are prone to vandalism and have to be repaired fairly regularly already. Drinking and this sort of behaviour go hand in hand.

As stated, we are not against a development here but it should be in keeping with other local pubs and restaurants.

[REDACTED]
Nick and Kate Foster

██████████
██████████ High Street
Roydon
Essex
CM19 5EH

11th December 2015

Dear Sirs

RE: Notification of Consultation for Just at the Station Ltd

I am writing to make a representation in respect to the prevention of public nuisance of the Licensing Act 2003 with regards to the licensing hours submitted by Just at Station Ltd, 185 High Street, Roydon, CM19 5EQ.

My family and I (I have two young children) live 10-15 yards from the premises and have done so for 15 years. During our time at ██████ High Street, Roydon we have experienced customers of the restaurant, under the previous occupants, leaving noisily in the early hours of the morning, smoking and drinking outside our property during the day and at night, and customers leaving bottles on our drive and by our fence. We had a good relationship with the previous occupants, however we did have to request some respect to us as a family.

We also had to request the previous occupants to turn down the recorded music after midnight and keep the doors and windows closed to reduce the level of noise and customers also sat on the porch/veranda to eat and drink well into the night especially during the summer months. If the licensing hours are to be extended until the early hours of the morning in an old property with no sound proofing or double glazing, the noise would become even more audible and therefore a public nuisance to us and other nearby residents for a longer period of time.

Whilst we understand this is a new application the hours requested are for much longer than previously and this would lead to customers leaving the restaurant later and drinking and smoking outside into the early hours of the morning. **I would therefore like the committee to consider that all licensing activities between Sunday – Thursday to cease at 23.00 and at Midnight on Friday and Saturday (with the music being turned down at 11.30).**

We would also like the committee to consider where on the property alcohol is drunk and served as the previous occupants allowed alcohol to be consumed within the station car park and outside our property whilst customers smoked. We would like in writing how the applicant will prevent this from happening.

I hope you understand and consider our representation and we await your response.

Yours faithfully

Lynn Barnett
(On behalf of the Barnett family)

Sarah Moran

From: Alan Beal-Forbes [REDACTED]
Sent: 12 December 2015 09:59
To: Licensing
Subject: RE: APPLICATION FOR NEW PREMISES LICENCE UNDER THE 2003 ACT BY JUSTATTHE STATION LTD IN RESPECT OF 185 HIGH STREET ROYDON ESSEX CM195EH

Dear Sirs

With regards to item No.5 of my email of 9/12/15 that as my property [REDACTED] and 191 High Street will be materially affected by various items in the proposed licence(if granted) then in relation to "Live music", "Performance of dance", "Provision of facilities for dancing", "Recorded music" and "late night refreshment" these should be restricted in such licence to Friday and Saturday nights only. Given the area and my description of Roydon village as set out in my said email I would have thought, on consideration, that "Late night refreshment" is entirely inappropriate and unnecessary-is any one getting off the last train from London(00.27 Saturdays and 00.27 Mon-Friday) going to "drop in" for a drink at that hour?

Clearly as Roydon is a commuter village(Abellio Greater Anglia could no doubt supply statistics to you and the applicant) then the timings of everything should be midnight or even 11.30pm(this latter on Sundays).

As a matter of interest ,and importance,to the village ,I assume that Abellio Greater Anglia will be able to comment on the applicant`s application as I assume from the original notice affixed to the exterior window fronting the station forecourt(now quite a few months ago) that AGA is the landlord/owner who would be entitled to grant a lease.No doubt you will establish whether this supposition is correct .Can we assume also that Network Rail was served with a copy of the EFDC Notice as they maintain the rail tracks I believe?

For the avoidance of doubt my comments in this email fall mostly with the grounds of public nuisance and public safety and the other grounds so far as may be relevant to such comments.

I would ask please that these points should be considered by the sub-committee also.

Yours faithfully
Alan Beal-Forbes

From: Alan Beal-Forbes [REDACTED]
Sent: 09 December 2015 19:09
To: 'licensing@eppingforestdc.gov.uk'
Subject: APPLICATION FOR NEW PREMISES LICENCE UNDER THE 2003 ACT BY JUSTATTHE STATION LTD IN RESPECT OF 185 HIGH STREET ROYDON ESSEX CM195EH

TO THE LICENSING TEAM EPPING FOREST DISTRICT COUNCIL CIVIC OFFICES HIGH STREET EPPING CM16 4BX

DEAR SIRS

With regard to the above application I am the owner of [REDACTED] High Street Roydon CM195EH which lies in the immediate vicinity of the subject premises.

Whilst I have no objection to the use of the premises as a "Mediterranean" Restaurant(the term "Mediterranean" being extremely wide as the Mediterranean laps the shores of numerous different countries with differing cultures as can be established by looking at a map in an atlas of that area) I would like bearing in mind the first paragraph to make some observations/objections which I should be glad could be taken into account in the sub-committee`s deliberations as follows:-

1.With regard to the 4 grounds permitted by the 2003 Act and as set out in your undated letter,it is the case(as presumably the sub-committee is aware from the Council`s records) that there are 4 licensed establishments in

Roydon Essex High Street to the "south" of the level crossing at Roydon Station, namely, The New Inn, The Crusader, The White Hart, and The Roydon House and Bar (formerly The White Horse) – the subject premises lying to the "north" of the level crossing immediately adjoining Roydon Station forecourt (being the former Franco's Italian Restaurant). In my view, given the very wide range of items set out in the Notice of Application which the Applicant seems to require, that any licence which the sub-committee may be minded to grant, should be similar to and reflect those currently in force in relation to the 4 licensed premises mentioned above and perhaps reflect what was granted to Franco's now defunct restaurant save that the "end" times of each item mentioned in the Notice should be 12 midnight in each case (subject to my observations in item 4 of this email).

2. On the grounds of public safety and the prevention of public nuisance, Roydon High Street (both "north" and "south" of the level crossing) is a quiet residential area generally (except perhaps in the rush hours as presumably the sub-committee is aware) while Roydon itself is essentially a commuter village (serving both London and Cambridge) hence my suggestion that the "end" times in the Notice should be altered to 12 midnight in each case.

3. Also on the grounds of public safety and the prevention of public nuisance, as the sub-committee is aware, smoking within the subject premises is forbidden by statute so this is likely to take place on Roydon Station forecourt (hopefully not on Platform 2) which raise the question of the applicant's clientele drinking on such forecourt (if this permitted under any licence which may be granted and if permitted by Abellio Greater Anglia or other the owner thereof). If this is the case then such area should be properly defined on a plan attached to any licence and somehow indicated to such clientele as it should be borne in mind that such forecourt fronts the main road which is the B181 under the control of Essex CC and is somewhat narrow (as can be seen by inspection) and (as mentioned above) is very busy with heavy traffic during rush hours. Use by commuters and others going to and from the Station carpark (run by NCP) over the forecourt should, I would respectfully suggest, be taken into account when considering what conditions should be included in any proposed licence. This aspect wouldn't apply, as such to any licences relating to the 4 establishments set out above.

4. With reference to the prevention of public nuisance, bearing in mind I do not know what was contained in any licence granted in the past when it was Franco's It. Restaurant and in view of the closeness of both 193 and 191 High Street to the subject premises, please would the sub-committee consider that should the applicant wish to have "live music" (one assumes that this includes bands), "performance of dance", "provision of facilities for dancing" and "late night refreshments", the applicant should be required as one of the conditions in any licence, to make a separate application to the licensing authority on each and every occasion with any timings to fall in line with what might have been granted to the 4 establishments set out above subject to any objections being received or the timings mentioned in item 2 above.

5. Provided I do not exceed the deadline imposed in your Notice of 17th November 2015, I would like (if I may) to reserve the right to put forward any further objections/observations which I might consider of assistance to the sub-committee.

6. I would be pleased if the sub-committee would consider the above points which I trust will be of some assistance in deciding the Applicant's application.

7. I shall be pleased to receive notice of any hearing which might occur in the future and of the ultimate decision by the sub-committee in this matter.

Yours faithfully

Alan Beal-Forbes

Sarah Moran

From: roydon.council@btinternet.com
Sent: 12 December 2015 01:04
To: Licensing
Subject: Just....at the Station Ltd

Dear Licensing

Roydon Parish Council wishes to object to the terms of the license as proposed (notice dated 17th November).

The Parish Council believes that the licensing of these premises until as late as 01.30am would cause unacceptable noise disruption to the neighbouring properties and that a license which is more in keeping with the closing times of the local village public houses would be more appropriate. The business could apply for a late licence on an individual basis but with residential properties so close by we would request that a decibel meter be installed to monitor noise/disruption levels on these occasions as there would be very little in the way of other noise in the village at such a late hour.

Many thanks,

Janet Ballard
Clerk to Roydon Parish Council
P O Box 10752
Bishops Stortford
CM23 9GN

Tel/Fax 01279 730475

This email is intended only for the addressee named above and may contain confidential or privileged information. It must not be copied, forwarded or disclosed to any unauthorised person. If you are not the intended recipient, please notify us immediately by return email. We have taken precautions to minimise the risk of transmitting software viruses, but we advise you to carry out your own virus checks on any attachment to this message. Roydon Parish Council accepts no liability for any loss or damage caused by software viruses.

Sarah Moran

From: Kingsley Sleep <[REDACTED]>
Sent: 11 December 2015 15:52
To: Licensing
Subject: New premises licence for 'Just at the Station'

From: [REDACTED]

Sent: 10th December 2015

To: licensing@eppingforestdc.gov.uk

Subject: Licence application 'Just at the Station, Roydon' ref. WK/201548144

Dear Sir or Madam

I refer to the above application.

There is no public transport available in Roydon after midnight and all means of access to and departure from the village are via unlit country roads mostly without footpaths.

The establishment described is immediately adjacent to an un-gated platform on the London to Stansted Airport and Cambridge main railway line.

Anyone leaving the premises after midnight, in the dark and under the influence of alcohol would create a serious public safety risk to vehicular or train traffic and also to themselves.

By the same token, being inebriated and stranded in the village, they are likely to cause a public nuisance as would the music which it is proposed would continue until 01.00 hrs or 01.30hrs every night of the week.

I am not opposed to the application in principle but strongly feel that its licence should be no different to that of other establishments in the village.

Kingsley Sleep

[REDACTED] The Granary

Roydon, Essex

CM19 5EL

[REDACTED]

Sarah Moran

Subject: FW: Objection to Licence application: Just at the Station, Roydon Station

From: Jill Ludlow [REDACTED]
Sent: 21 November 2015 14:26
To: Licensing
Cc: cllr.anthony.jackson@essex.gov.uk; marysartin@yahoo.com
Subject: Objection to Licence application: Just at the Station, Roydon Station

Dear Sirs

Thank you for your letter of 18 November 2015, ref WK/201548144. I live in The Granary CM19 5EL. I have concerns about overspill parking from Just at the Station ending up in The Granary causing noise and disturbance in the early hours *every day of the week* as customers collect their vehicles. Parking in The Granary is already a problem, in spite of the CPZ and yellow lines. Inconsiderate, hazardous parking and waiting (for commuting passengers from the station) occurs most weekdays, and commuter collection and Just at the Station parking will certainly overlap while the geography of The Granary means on-street parking in much of the road may cause a hazard.

I also have concerns that customers could think the tow path to Roydon Mill would be a good parking spot if there was inadequate provision for free parking. There is a footpath which runs from The Granary between two houses, and where it meets the tow path at the junction with High Street has attracted long term, four wheels-up, parking this year, with subsequent risk to utilities conduited below, as well as inconvenience to pedestrians. When I contacted Essex CC they seemed to think this was not a problem; I'm not convinced the residents of The Granary, which experiences relatively frequent power cuts, share this relaxed view. There are also areas along the towpath at the rear of properties in The Granary, where there is a maintenance/service strip of land between the carriageway and the back fences, which might also prove tempting as overspill parking.

In respect of noise, I do not see that the owners, especially during the summer, would be able to contain the noise of recorded or live music within the confines of the building, and while your letter shows opening times, disbursement of Just at the Station's clientele could carry on long after its advertised closing time of 1.30 am.

Therefore, on the above bases, I formally object to any licence application received by yourselves with the timings currently shown and without adequate and comprehensive plans for free, immediately adjacent parking.

I do so in particular as yesterday I received a letter from Roydon Marina telling of their proposal to increase their number of berths by 252 and this, when taken with the advertised opening time of 11.00 am, leads to concerns about the amount of traffic the combined proposals may generate especially at summer weekends. This year I had cause to contact Epping Forest Noise Abatement after power tools were used on a longboat in conjunction with a generator for two whole days. The additional noise of traffic trying to access Roydon Marina due to inconsiderate parking by longboat owners added to the nuisance.

At present no evidence has been shown that the applicants are taking any appropriate precautions to ensure noise and disturbance at all times, especially in the early hours, *including Sunday*, are minimised and confined to the immediate area. All consequences of Just at the Station's business should remain just at the station.

Yours faithfully
GV Ludlow (Mrs)
[REDACTED] The Granary
Roydon
Essex
CM19 5EL

Sarah Moran

Subject: FW: Licence Application for "Just at the Station" in Roydon Ref WK/201548144

From: [REDACTED]

Sent: 26 November 2015 14:41

To: Licensing

Cc: [REDACTED]

Subject: Licence Application for "Just at the Station" in Roydon Ref WK/201548144

Dear Sir/Madam,

I have received your letter dated 18th November on the above subject.

I wish to state my objections to the proposal for the following reasons.

1. The premises are small, if not tiny and the floor space is inappropriate for the "Performance of Dance, Live Music, Dancing" as indicated by the licencing application, particularly if the main business is to be as a restaurant - see next point.
2. While the applicant is describing themselves as a "restaurant", they clearly will not do so in the event that they open. If you have restaurant tables you have no room for music and dancing. Hence they are almost certainly looking to be a bar and club with dancing which offers a modest, probably tap type finger menu.
3. The building itself is primarily wood with no double glazing or I believe cavity walls to absorb sound. Hence noise intrusion to local residents from Live Music and Recorded Music will be annoying.
4. Trains from Roydon Station finish just after midnight. If drinking is allowed until 01.30, seven days a week then the only way people can get home will be by taxi or car. If people are allowed by the licencing authority to drink alcohol until well after the last train has left then it could be argued you are encouraging some people to drink drive.
5. Developing the previous point of driving having drunk alcohol, customers will need to drive along unlit, twisting country roads from Roydon where you need all of your wits about you. Drinkers will not be able to do so.
6. It is inconceivable that there is a need for late night drinking, dancing and a live music venue operating into the early hours in Roydon on Sunday, Monday, Tuesday, Wednesday and Thursday evenings. A later licence on Friday and Saturday evenings might be warranted but not beyond midnight.
7. In the village we currently have four bar/restaurants which all operate successfully on normal pub licencing hours. Hence why would a new operation require longer hours - the need has not been proven.
8. If the above is pulled together - the use of the premises as a music venue is inappropriate, there is no demand for a late night venue in Roydon and the noise from the premises themselves and no doubt revellers leaving in the early morning would be an intrusion no one in Roydon would welcome or be exposed to.

Rod Taylor

[REDACTED] The Granary,

Roydon Essex

CM195EL

Sarah Moran

From: Neil Maurer [REDACTED]
Sent: 14 December 2015 10:54
To: Licensing
Subject: License Application for 'Just at the Station, Roydon'

Your Ref: WK/201548144

Dear Sir/Madam,

I am writing to you concerning the above application for a license for a new restaurant at Roydon station.

This premises is adjacent to the level crossing and only accessible via narrow country lanes or Roydon High Street. The result of this would be that anyone leaving the restaurant late and under the influence of alcohol would face a difficult and possibly hazardous journey home. In addition the allowance of live music playing late could also create a public nuisance.

We have had a restaurant on this site for many years and this was a welcome addition to the village amenities. It would seem to make sense to limit the license to the same as the other pubs and restaurants in the village.

Your Faithfully
Neil Maurer
■ The Granary
Roydon
CM19 5EL

THE ROYDON SOCIETY

Hon Sec: S N Wilkinson, [REDACTED] Harlow Road, Roydon,
Harlow, Essex, CM19 5HH

4 December 2015

Licensing Office
High Street
Epping, Essex
CM16 4BZ

Attn: Ms S Moran

Dear Ms Moran

Just at the Station Ltd, Roydon Station, 185 High Street, Roydon Essex CM19 5EA

Local residents have contacted The Roydon Society of their concerns at the late hours that this new business will be operating which requires a license. Whilst the Society appreciates that the business may wish to attract customers from the later trains that stop at the village station, it is thought that recorded/live music after 11.30pm each evening maybe very disturbing for the residents opposite as well as the residents living nearby in The Granary and towards the village in the High Street. Roydon at that time of night is usually very quiet and as we know for experience noise carries. Residents know only too well that when Briggins Hotel was operating, any loud late music could be heard in the village. I see this application as similar to Briggins operating during these hours.

Local public houses respect local residents and cease music/live performances at a respectable hour. However, I have to add that these performances are held on an ad hoc basis and not possibly every evening as indicated in this application. It may well be that this new business finds it more sensible to ask for a license to cover the whole week rather than apply for such a license for 'special' occasions. Maybe this could be confirmed?

Please keep me informed of the progress of this application.

Yours sincerely,

[REDACTED]

S N Wilkinson - Hon Sec

Tel: (01279) [REDACTED]

Fax: (01279) [REDACTED]

email: [REDACTED]

[REDACTED] High Street,

Roydon,

Nr. Harlow,

Essex. CM19 5EQ

4.12.15.

Dear Sir,

As houseolders of Roydon village, in proximity to the station, we welcome the renewed use of the restaurant facility which has now become disapidated.

We do have concerns and these relate to extended hours for serving alcohol and a licence for live and recorded music continuing after midnight.

The high street already suffers from noise and discarded litter from pub users. There is also very limited parking at the restaurant and possible danger to any person seriously inebriated. One drowning

has occurred under such circumstances reported in the last 5 years.

The river towpath, canal bridge and level crossing are all within 20 metres of the station.

We request that these facts are considered before the requested licences are granted.

Yours faithfully,

A solid black rectangular box redacting the signature of the sender.

(D.S. & B.J. NAIRN)